

Main Floor M/E/P Plan 1/4 in = 1 ft

FIXTURE SCHEDULE							
NUMBER	LABEL	QTY	FLOOR	WIDTH	DEPTH	HEIGHT	DESCRIPTION
A01	CABINET WATER SOFTENER	1	1	22"	18"	46 9/16"	CABINET WATER SOFTENER
A02	42" OPEN FRONT [42W]	1	1	42"	20"	45"	42" OPEN FRONT [42W]
A03	CLOSET SHELF W/ ROD	1	2	125 9/16"	18 7/8"	13"	CLOSET SHELF W/ ROD
A04	CLOSET SHELF W/ ROD	1	2	76 1/2"	18 7/8"	13"	CLOSET SHELF W/ ROD
A06	CLOSET SHELF W/ ROD	1	2	83 1/2"	18 7/8"	13"	CLOSET SHELF W/ ROD
A07	FRONT LOADING CLOTHES WASHER	1	2	26 7/8"	28 7/8"	42 11/16"	FRONT LOADING CLOTHES WASHER
A08	GAS RANGE	1	1	30"	24 1/4"	47 1/4"	GAS RANGE
A09	GLASS FRONT CLOTHES DRYER	1	2	26 7/8"	28 7/8"	42 11/16"	GLASS FRONT CLOTHES DRYER
A10	OFFSET UNDERMOUNT SINK [24 5/8W]	1	1	24 5/8"	14 3/4"	23 1/16"	OFFSET UNDERMOUNT SINK [24 5/8W]
A11	OVAL UNDERMOUNT SINK [20 3/4W]	4	2	20 3/4"	14 7/16"	14"	OVAL UNDERMOUNT SINK [20 3/4W]
A12	PEDESTAL SINK 10	1	1	24 7/16"	20 1/2"	34 5/16"	PEDESTAL SINK 10
A13	RECT (MEDIUM) [48]	1	2	48"	33 1/16"	74 9/16"	RECT (MEDIUM) [48]
A14	STANDARD TOILET	1	1	30"	36"	28 9/16"	STANDARD TOILET
A15	STANDARD TOILET	2	2	30"	36"	28 9/16"	STANDARD TOILET
A16	SLIPPER BATHTUB	1	2	74 1/4"	37 7/8"	42 1/4"	SLIPPER BATHTUB
A17	TUB-SHOWER 1	1	2	60 1/4"	33"	74 9/16"	TUB-SHOWER 1
A18	WALL MOUNTED MIRROR	1	1	24"	3/4"	36"	WALL MOUNTED MIRROR
A19	WALL MOUNTED MIRROR	1	2	48"	3/4"	36"	WALL MOUNTED MIRROR
A20	WALL MOUNTED MIRROR	1	2	60"	3/4"	36"	WALL MOUNTED MIRROR
A21	DN	1	1	23 3/4"	23"	24 1/4"	INTEGRATED DISHWASHER
A22	R36"	1	1	36"	34 11/16"	70 1/2"	DOUBLE DOOR REFRIGERATOR 1
A23	OVER THE RANGE MICROWAVE	1	1	30"	14 3/16"	17 1/8"	OVER THE RANGE MICROWAVE
A24	CLOSET SHELF W/ ROD	1	2	117"	18 7/8"	13"	CLOSET SHELF W/ ROD
A25	18" GAS FURNACE [18W24D]	1	1	18"	24"	48"	18" GAS FURNACE [18W24D]
A26	TANKLESS WATER HEATER	1	1	15 3/4"	9"	28"	TANKLESS WATER HEATER

ELECTRICAL SCHEDULE										
NUMBER	QTY	FLOOR	WIDTH	DEPTH	HEIGHT	ATTACHED TO	DESCRIPTION	CODE	MANUFACTURER	COMMENTS
E01	5	2	5"	5"	1 1/8"	CEILING	SMOKE DETECTOR 1			
E02	1	1	14 1/4"	3 3/8"	23"	WALL	ELECTRICAL PANEL - RECESSED			
E03	1	1	5"	5"	1 1/8"	CEILING	SMOKE DETECTOR 1			
E04	1	1	5"	5"	1 1/8"	CEILING	CO/SMOKE DETECTOR			
E05	1	1	16"	16"	5"	CEILING	EXHAUST FAN 01			
E06	2	2	16"	16"	5"	CEILING	EXHAUST FAN 01			

ELECTRICAL - DATA - AUDIO LEGEND	
SYMBOL	DESCRIPTION
	Ceiling Fan
	Ventilation Fans: Ceiling Mounted, Wall Mounted
	Ceiling Mounted Light Fixtures: Surface/Pendant, Recessed, Heat Lamp, Low Voltage
	Wall Mounted Light Fixtures: Flush Mounted, Wall Sconce
	Chandelier Light Fixture
	Fluorescent Light Fixture
	240V Receptacle
	110V Receptacles: Duplex, Weather Proof, GFCI
	Switches: Single Pole, Weather Proof, 3-Way, 4-Way
	Switches: Dimmer, Timer
	Audio Video: Control Panel, Switch
	Speakers: Ceiling Mounted, Wall Mounted
	Wall Jacks: CAT5, CAT5 + TV, TV/Cable
	Telephone Jack
	Intercom
	Thermostat
	Door Chime, Door Bell Button
	Smoke Detectors: Ceiling Mounted, Wall Mounted
	Electrical Breaker Panel

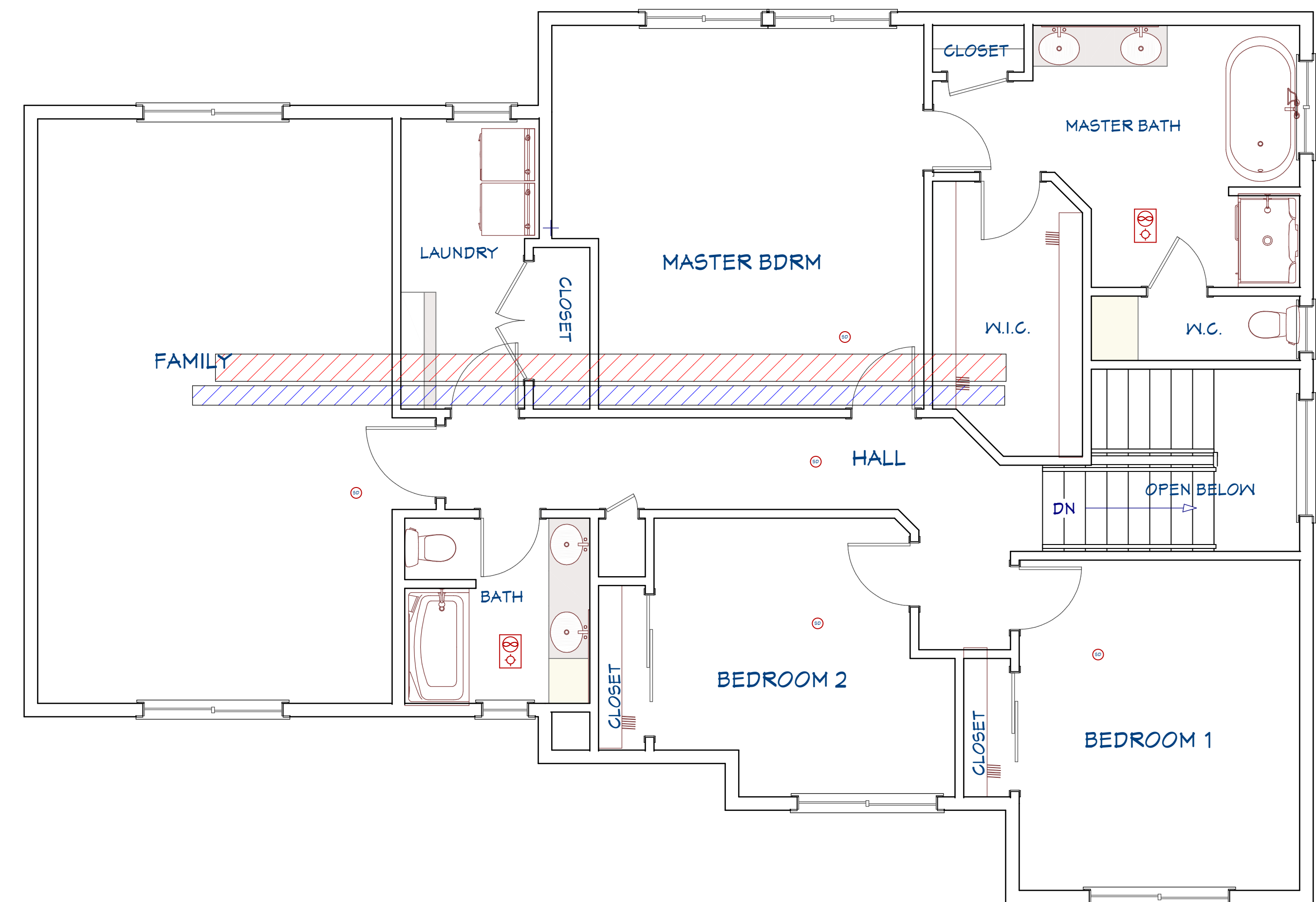

2nd Floor M/E/P Plan 1/4 in = 1 ft

HVAC PLAN KEY	
	RETURN DUCT
	SUPPLY DUCT

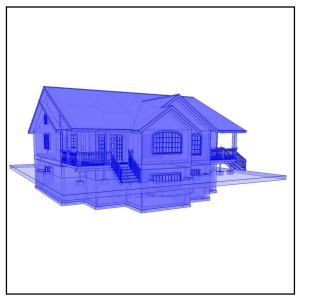

REVISION TABLE	DESCRIPTION
NUMBER	DATE

Frank Revard
406-300-2070
frevard@gmail.com

MECH/ELEC/PLUMB

DRAWINGS PROVIDED BY:
Mike Gorecki
Big Sky Custom Home Design, LLC
406-231-6392
bigstychnd@gmail.com

DATE:

6/23/2022

SCALE:

SHEET:

P-12